

8 FILTERS AND ACCESSORIES



Vacuum filter VF 8.2



Ventilation filter BF 8.4



Hose nipples SN 8.6



Screw-on connections EV 8.8



Vacuum hose line VS 8.10



Sealing rings DR 8.13



Vacuum distributors VTB 8.14



Revolving vacuum feeders DVZ 8.16



Quick-change coupling SWK 8.18



Water separator WA 8.20

Description

Vacuum filters with exchangeable micro-filter cartridges. The vacuum filters are mounted in on the suction side in front of vacuum pumps, valves and other switching devices. The extremely high degree of elimination (almost 100 %) makes them especially suitable in dusty areas.



Filterpatronen



Vacuum filter VF-1/2



Vacuum filter VF-3/4 to VF-1 1/4 B (with housin g)

Mounting Advice:

Never mount the filter with the clean air nozzle (exit to the pump) to the bottom, because then dirt particles can fall into the distributor line, when exchanging the filter cartridge!

Article numbers

Type	Filter	Filter cartridge
VF-1/2	1.53.2.0002	2.53.2.0009
VF-3/4	1.53.2.0016	2.53.2.0014
VF-1 1/4A	1.53.2.0003	2.53.2.0005
VF-11/4B	1.53.2.0004	2.53.2.0004
VF-21/2	1.53.2.0005	2.53.2.0006

Technical Data

Type	Gewicht (kg)	Durchfluß (m ³ /h)	passender Schlauchnippel
VF-1/2	0,72	12	SN-R1/2-1/2
VF-3/4	0,59	42	SN-R3/4-3/4
VF-11/4A	1,06	96	SN-R1 1/4-38
VF-11/4B	1,25	108	SN-R1 1/4-38
VF-21/2	1,88	360	--

Flow with p = 10 mbar and clean filter cartridge

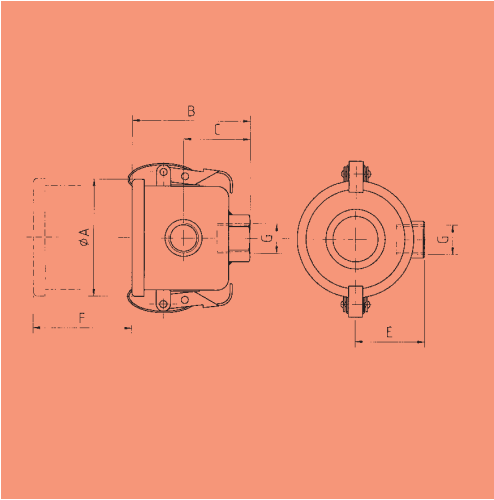

Vacuum filter 3/4" in mounting position - clean air nozzle on the top

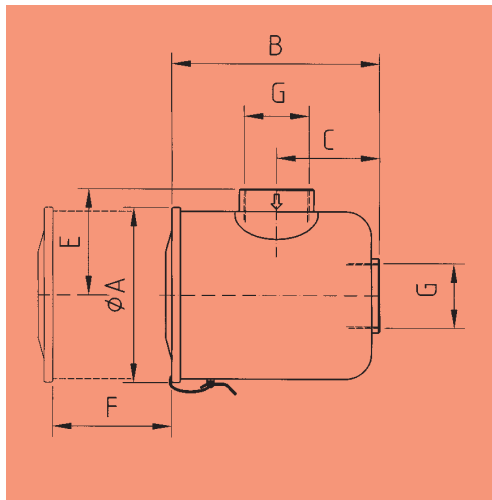

Vacuum filter 1/2"

Dimensions						
Type	A (mm)	B (mm)	C (mm)	E (mm)	F (mm)	G
VF-1/2"	82,5	82,5	46,5	49	70	G 1/2"
VF-3/4"	97	89,5	45	59	70	G 3/4"
VF-1 1/4" A	136	116	68	81	75	G 1 1/4"
VF-1 1/4" B	172	170	108	98	130	G 1 1/4"
VF-2 1/2"	194	247	119	123	215	G 2 1/2"

Description

Robust ventilation filter with stable sheet metalhousing.

Suitable for mounting on valves, to prevent dirt particles from getting into the vacuum circuit when ventilating. Recommended especially when using magnetic valves, because in this case, high velocities of flow emerge during ventilation.

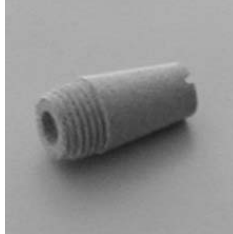

Ventilation filter BF-R1/4



Ventilation filters BF-R1/2 to BF-R1 1/2

Maintenance: When cleaning, use compressed air to blow the ventilation filter against the suction direction.

Article numbers

Type	Ventilation filter
BF-R1/4	1.53.1.0004
BF-R1/2	1.53.1.0003
BF-R3/4	1.53.1.0008
BF-R1	1.53.1.0009
BF-R1 1/2	1.53.1.0010

Technical Data

Type	Weight (kg)	Flow ¹⁾ (m ³ /h)
BF-R1/4	0,02	45
BF-R1/2	0,1	70
BF-R3/4	0,12	70
BF-R1	0,16	86
BF-R1 1/2	0,33	100

1) Flow with $\Delta p = -950$ mbar

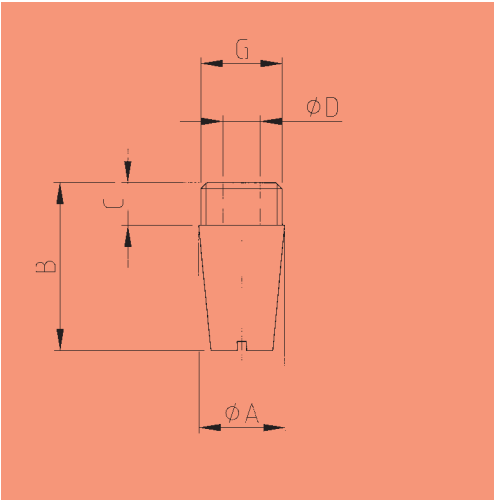

Ventilation filter BF-R1/4

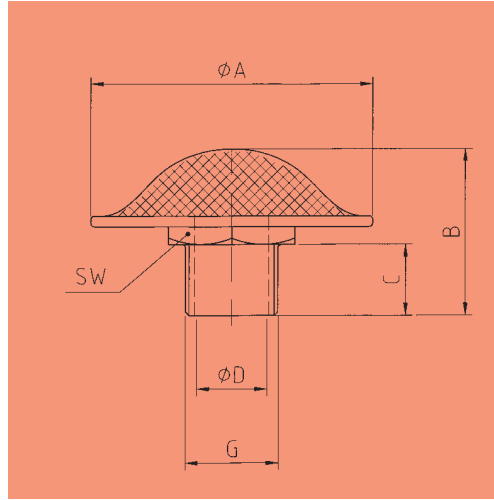

Ventilation filters BF-R1/2 to BF-R1

Dimensions						
Type	A	B	C	D	G	SW
BF-R1/4	14	27	8	6	R 1/4"	---
BF-R1/2	80	45	11	16	R 1/2"	27
BF-R3/4	80	47	20	21	R 3/4"	36
BF-R1	80	47	20	27	R 1"	46

Description

Hose nipples for connecting vacuum components by means of a vacuum hose. The hose nipples are made of galvanized steel and available with different hose connections and threads. It is a must to use sealing band and sealing rings when mounting, in order to prevent unnecessary leakages. We recommend to use hose clips to secure the hose connections.

Standard scope of supply:
 Hose nipple with sealing ring.



Hose nipples with different connections and widths

Article numbers

Type	Hose nipple
SN-R 1/8-6	1.54.1.0011
SN-R 1/4-6	1.54.1.0008
SN-R 1/4-10	1.54.1.0007
SN-R 1/4-1/2	1.54.1.0006
SN-R 3/8-10	1.54.1.0017
SN-R 3/8-1/2	1.54.1.0016
SN-R 1/2-1/2	1.54.1.0005
SN-R 3/4-1/2	1.54.1.0003
SN-R 3/4-3/4	1.54.1.0015
SN-R 1-1	1.54.1.0012
SN-R 1 1/4-38	1.54.1.0014
SN-R1 1/2-38	1.54.1.0013

Technical Data

Type	Weight (kg)	Inside dia. hose
SN-R 1/8-6	0,012	6
SN-R 1/4-6	0,018	6
SN-R 1/4-10	0,03	10
SN-R 1/4-1/2	0,038	1/2"
SN-R 3/8-10	0,042	10
SN-R 3/8-1/2	0,048	1/2"
SN-R 1/2-1/2	0,07	1/2"
SN-R 3/4-1/2	0,123	1/2"
SN-R 3/4-3/4	0,107	3/4"
SN-R 1-1	0,212	1"
SN-R 1 1/4-38	0,385	38
SN-R1 1/2-38	0,452	38

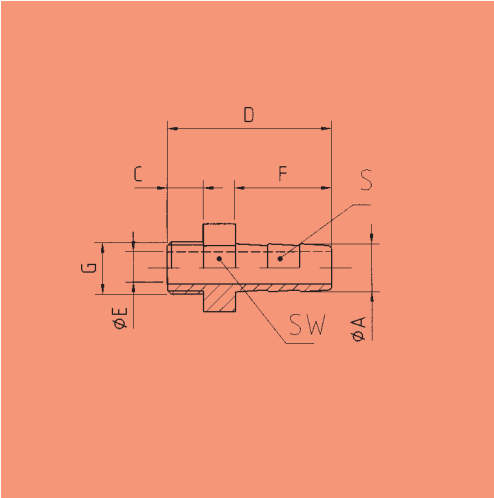

Hose nipples SN-R1/8 to SN-R3/4

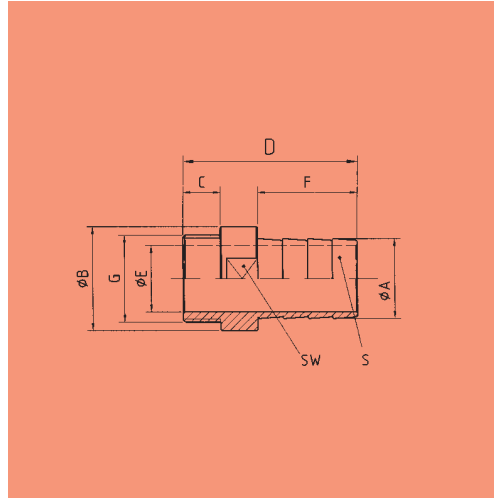

Hose nipples SN-R1 and bigger

Dimensions									
Type	A	B	C	D	E	F	G	S	SW
SN-R 1/8-6	9	---	9	34	6	20	R 1/8"	6	14
SN-R 1/4-6	9	--	9	34	6	20	R 1/4"	6	17
SN-R 1/4-10	12	--	9	41	8	24	R 1/4"	10	19
SN-R 1/4-1/2	15	--	9	41	8	24	R 1/4"	1/2"	19
SN-R 3/8-10	12	--	9	41	8	24	R 3/8"	10	22
SN-R 3/8-1/2	15	--	9	41	11	24	R 3/8"	1/2"	22
SN-R 1/2-1/2	15	--	10	50	11	30	R 1/2"	1/2"	27
SN-R 3/4-1/2	15	--	12	54	11	30	R 3/4"	1/2"	32
SN-R 3/4-3/4	21	--	12	64	17	40	R 3/4"	3/4"	32
SN-R 1-1	26,5	42	16	79	22	48	R 1"	1"	36
SN-R 1 1/4-38	38,5	50	18	84	32	48	R1 1/4"	38	46
SN-R 1 1/2-38	38,5	55	18	84	32	48	R1 1/2"	38	50

Description

Special fittings for vacuum hose lines of PE material without wire lining.

Straight fitting (EVG) with cylindrical thread and high-quality seal.

Elbow fitting (EVW) with conical thread.

T fitting (EVT) with conical thread.

Elbow fitting (EVWD) turnable with cylindrical thread and high-quality seal.



Elbow fitting EVW



T-fitting EVT



Fittings

Article numbers

Type	Fitting
EVG-6/4-R1/4	6.29.2.0015
EVG-8/6-R1/4	6.29.2.0016
EVG-10/8-R1/2	6.29.2.0013
EVG-12/10-R1/2	6.29.2.0014
EVW-6/4-R1/4	6.29.2.0026
EVW-8/6-R1/4	6.29.2.0028
EVW-8/6-R1/2	6.29.2.0027
EVW-10/8-R1/2	6.29.2.0024
EVW-12/10-R1/2	6.29.2.0025
EVT-6/4-R1/4	6.29.2.0019
EVT-8/6-R1/4	6.29.2.0020
EVT-10/8-R1/2	6.29.2.0017
EVT-12/10-R1/2	6.29.2.0018
EVWD-6/4-R1/4	6.29.2.0022
EVWD-8/6-R1/4	6.29.2.0023
EVWD-10/8-R1/4	6.29.2.0021

Technical Data

Type	Thread	Exits (I.D.)	Weight (g)
EVG-6/4-R1/4	R 1/4"	4	23
EVG-8/6-R1/4	R 1/4"	6	26
EVG-10/8-R1/2	R 1/2"	8	50
EVG-12/10-R1/2	R 1/2"	10	55
EVW-6/4-R1/4	R 1/4"	4	22
EVW-8/6-R1/4	R 1/4"	6	23
EVW-8/6-R1/2	R 1/2"	6	53
EVW-10/8-R1/2	R 1/2"	8	58
EVW-12/10-R1/2	R 1/2"	10	63
EVT-6/4-R1/4	R 1/4"	4	32
EVT-8/6-R1/4	R 1/4"	6	35
EVT-10/8-R1/2	R 1/2"	8	83
EVT-12/10-R1/2	R 1/2"	10	95
EVWD-6/4-R1/4	R 1/4"	4	29
EVWD-8/6-R1/4	R 1/4"	6	31
EVWD-10/8-R1/4	R 1/4"	8	41

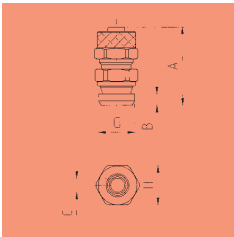

Fitting EVG

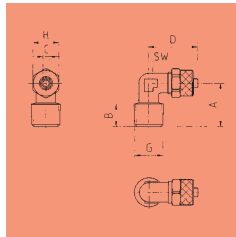

Fitting EVW

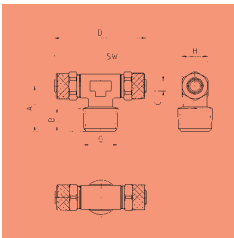

Fitting EVT

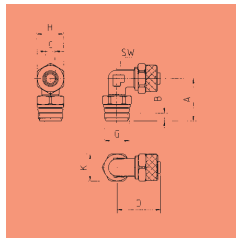

Fitting EVWD

Dimensions

Type	A	B	C	D	G	H	SW	K
EVG-6/4-R1/4	20,5	4,1	3	--	R 1/4"	12	--	--
EVG-8/6-R1/4	20,5	4,1	5	--	R 1/4"	14	--	--
EVG-10/8-R1/2	23,5	5	6,5	--	R 1/2"	16	--	--
EVG-12/10-R1/2	23,5	5	8,5	--	R 1/2"	19	--	--
EVW-6/4-R1/4	20,5	11	3	22,5	R 1/4"	12	10	--
EVW-8/6-R1/4	20,5	11	5	22,5	R 1/4"	14	10	--
EVW-8/6-R1/2	28	14	5	26,5	R 1/2"	14	17	--
EVW-10/8-R1/2	28	14	6,5	28,5	R 1/2"	17	16	--
EVW-12/10-R1/2	28	14	8,5	30,5	R 1/2"	19	17	--
EVT-6/4-R1/4	20,5	11	3	45	R 1/4"	12	10	--
EVT-8/6-R1/4	20,5	11	5	45	R 1/4"	14	10	--
EVT-10/8-R1/2	28	14	6,5	57	R 1/2"	16	17	--
EVT-12/10-R1/2	28	14	8,5	61	R 1/2"	17	19	--
EVWD-6/4-R1/4	22,5	4,1	3	22,5	R 1/4"	10	12	17
EVWD-8/6-R1/4	22,5	4,1	5	22,5	R 1/4"	10	14	17
EVWD-10/8-R1/4	24,5	4,1	6,5	25	R 1/4"	12	16	17

Description

Special hoses (sometimes with wire lining), which guarantee a safe connection with all vacuum parts. The wire lining prevents a contraction of the hoses, even with enormous under-pressures.

We generally recommend to use hose clips for securing the vacuum hoses to hose nipples.

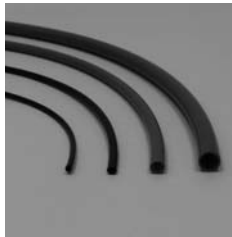

Pneumatic hose for vacuum



Black with wire support



Transparent with wire support

1 PVC with wire lining transparent:

Temperature range: $-5^{\circ}\text{C} \div +65^{\circ}\text{C}$

Highly flexible hose, even, non-abrasive

2 rubber with wire lining black:

Temperature range: $-40^{\circ}\text{C} \div +100^{\circ}\text{C}$

Elastomere-hose with inner textile- and steel wire and fabric-patterned, even lining.

3 PE blue:

Temperature range $-10^{\circ}\text{C} \div +40^{\circ}\text{C}$

4 NK red:

Natural rubber

Article numbers

Type	Vacuum hose by the meter	Vacuum hose by pre-packed units
VS-6-R	1.54.1.0040	1.54.1.0041
VS-10-T	1.54.1.0023	1.54.1.0026
VS-1/2-S	1.54.1.0018	1.54.1.0019
VS-1/2-T	1.54.1.0020	1.54.1.0021
VS-3/4-S	1.54.1.0031	1.54.1.0032
VS-3/4-T	1.54.1.0033	1.54.1.0034
VS-1-S	1.54.1.0027	1.54.1.0028
VS-1-T	1.54.1.0029	1.54.1.0030
VS-38-T	1.54.1.0035	1.54.1.0036
VS-4-B	1.54.1.0037	---
VS-6-B	1.54.1.0039	---
VS-8-B	1.54.1.0042	---
VS-10-B	1.54.1.0022	---

Technical Data

Type	Bending radius (mm)	Material	Weight (kg/ m)	Unit (m)	Volume (l/m)
VS-6-R	23	4	0,2	25	0,028
VS-10-T	20	1	0,16	30	0,079
VS-1/2-S	56	2	0,34	25	0,154
VS-1/2-T	30	1	0,35	30	0,154
VS-3/4-S	80	2	0,43	25	0,314
VS-3/4-T	50	1	0,38	30	0,314
VS-1-S	100	2	0,74	25	0,491
VS-1-T	60	1	0,51	30	0,491
VS-38-T	90	1	0,95	30	1,134
VS-4-B	30	3	0,014	--	0,013
VS-6-B	40	3	0,02	--	0,028
VS-8-B	60	3	0,026	--	0,05
VS-10-B	85	3	0,32	--	0,079

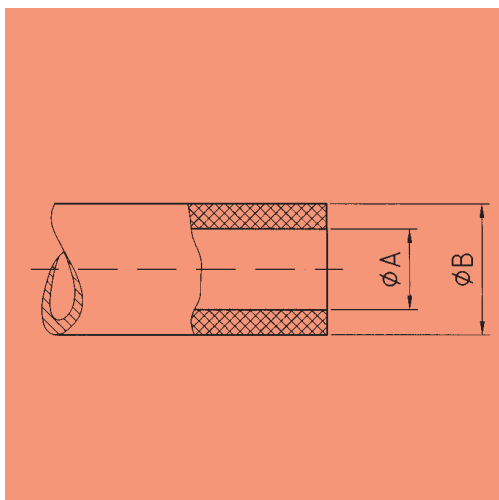

Vacuum hose

Dimensions		
Type	A	B
VS-6-R	6	14
VS-10-T	10	16
VS-1/2-S	14	21,5
VS-1/2-T	14	20
VS-3/4-S	20	28
VS-3/4-T	20	26,5
VS-1-S	25	33
VS-1-T	25	34
VS-38-T	38	50
VS-4-B	4	6
VS-6-B	6	8
VS-8-B	8	10
VS-10-B	10	12

Description

For securing vacuum hoses on hose nipples. The hose clips seal vacuum hoses on hose nipples and prevent the suction of leakage air. They also secure the vacuum hose against unintentional pulling off.

Advice

According to the german UVV* 18 hose connections on load lifting devices have to be secured against unintentional pulling off.

* UVV = Accident Prevention Regulations



Hose clips for securing hose connections

Technical Data	
Type	Weight (g)
SK-6	11
SK-10	13
SK-1/2	14
SK-3/4	14,5
SK-1	17
SK-38	18

Article numbers	
Type	Hose clip
SK-6	6.21.3.0006
SK-10	6.21.3.0003
SK-1/2	6.21.3.0002
SK-3/4	6.21.3.0004
SK-1	6.21.3.0001
SK-38	6.21.3.0005

Dimensions		
Type	A (Clamping area)	B
SK-6	8 ÷ 16	9
SK-10	12 ÷ 22	9
SK-1/2	14 ÷ 30	9
SK-3/4	20 ÷ 35	9
SK-1	26 ÷ 40	9
SK-38	38 ÷ 53	13

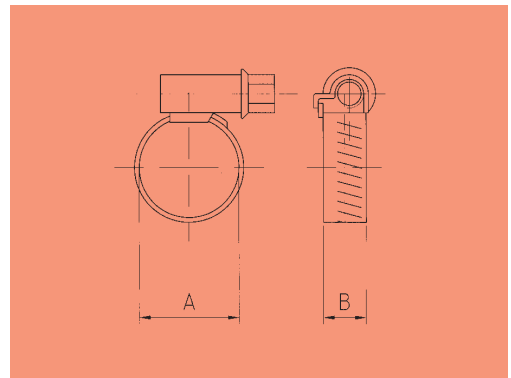

Hose clip SK

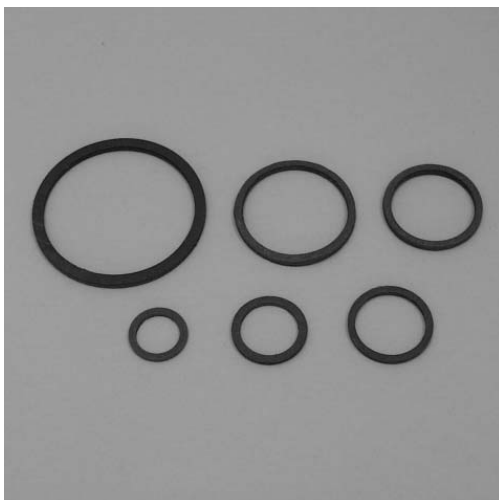

Sealing rings in vulcan-fibre-version

Description

Sealing rings are used to seal screwable mounting parts with inner vacuum feeders, as between bolts and hose nipples or between suction plate and bolts.

Material: vulcan-fibre

Article numbers

Type	Sealing ring
DR-M5	6.29.2.0002
DR-R1/8	6.29.2.0006
DR-R1/4	6.29.2.0005
DR-R3/8	6.29.2.0010
DR-R1/2	6.29.2.0004
DR-R3/4	6.29.2.0009
DR-R1	6.29.2.0003
DR-R1 1/4	6.29.2.0008
DR-R1 1/2	6.29.2.0007

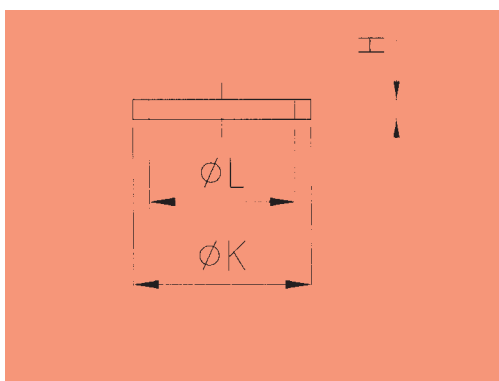

Sealing rings

Dimensions

Type	H	K	L
DR-M5	1	8	5,2
DR-R1/8	1,5	16	10
DR-R1/4	2	18	13
DR-R3/8	2	23	17
DR-R1/2	2	26	21
DR-R3/4	2,5	32	26,5
DR-R1	2,5	39	33
DR-R1 1/4	2,5	49	42
DR-R1 1/2	2,5	55	48

Description

Distributors are used for distributing the vacuum from one central unit to various suction places. A 2/2-way ball valve is mounted on every vacuum exit for switching on and off. In addition to that a 3/2-way manual slide valve can be mounted in at the vacuum entrance S 1, in order to control the entire distributor.

Manual slide valve see chapter 7:
 Control valves, measuring units.



VTB-4



VTB-8



VTB-12

Article numbers	
Type	Distributor
VTB-4-EIN-R1/2-AUS-6mm	1.54.2.0028
VTB-4-EIN-R1/2-AUS-10mm	1.54.2.0027
VTB-4-EIN-R3/4-AUS-6mm	1.54.2.0030
VTB-4-EIN-R3/4-AUS-10mm	1.54.2.0029
VTB-8-EIN-R1/2-AUS-6mm	1.54.2.0034
VTB-8-EIN-R1/2-AUS-10mm	1.54.2.0033
VTB-8-EIN-R3/4-AUS-6mm	1.54.2.0037
VTB-8-EIN-R3/4-AUS-10mm	1.54.2.0036
VTB-12-EIN-R1/2-AUS-6mm	1.54.2.0023
VTB-12-EIN-R1/2-AUS-10mm	1.54.2.0022
VTB-12-EIN-R3/4-AUS-6mm	1.54.2.0025
VTB-12-EIN-R3/4-AUS-10mm	1.54.2.0024

Technical Data			
Type	Connection	Exits Inside dia	Weight (kg)
VTB-4-EIN-R1/2-AUS-6mm	1/2"	6	0,87
VTB-4-EIN-R1/2-AUS-10mm	1/2"	10	0,92
VTB-4-EIN-R3/4-AUS-6mm	3/4"	6	0,9
VTB-4-EIN-R3/4-AUS-10mm	3/4"	10	0,95
VTB-8-EIN-R1/2-AUS-6mm	1/2"	6	1,42
VTB-8-EIN-R1/2-AUS-10mm	1/2"	10	1,57
VTB-8-EIN-R3/4-AUS-6mm	3/4"	6	1,45
VTB-8-EIN-R3/4-AUS-10mm	3/4"	10	1,6
VTB-12-EIN-R1/2-AUS-6mm	1/2"	6	1,97
VTB-12-EIN-R1/2-AUS-10mm	1/2"	10	2,17
VTB-12-EIN-R3/4-AUS-6mm	3/4"	6	2,0
VTB-12-EIN-R3/4-AUS-10mm	3/4"	10	2,2

Dimensions							
Type	A	B	C	D	E	F	H
VTB-4-EIN-R1/2-AUS-6mm	131	--	158	50	53	44	57
VTB-4-EIN-R1/2-AUS-10mm	131	--	168	50	53	44	57
VTB-4-EIN-R3/4-AUS-6mm	131	--	158	50	53	55	57
VTB-4-EIN-R3/4-AUS-10mm	131	--	168	50	53	55	57
VTB-8-EIN-R1/2-AUS-6mm	231	100	158	50	53	44	57
VTB-8-EIN-R1/2-AUS-10mm	231	100	168	50	53	44	57
VTB-8-EIN-R3/4-AUS-6mm	231	100	158	50	53	55	57
VTB-8-EIN-R3/4-AUS-10mm	231	100	168	50	53	55	57
VTB-12-EIN-R1/2-AUS-6mm	331	100	158	50	53	44	57
VTB-12-EIN-R1/2-AUS-10mm	331	100	168	50	53	44	57
VTB-12-EIN-R3/4-AUS-6mm	331	100	158	50	53	55	57
VTB-12-EIN-R3/4-AUS-10mm	331	100	158	50	53	55	57

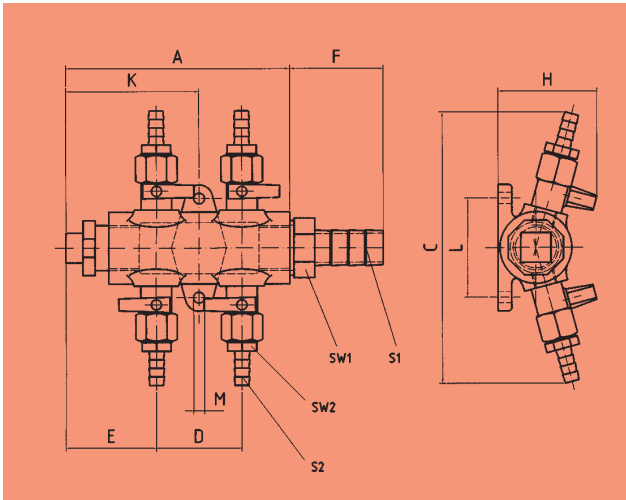

Vacuum distributors VTB-4

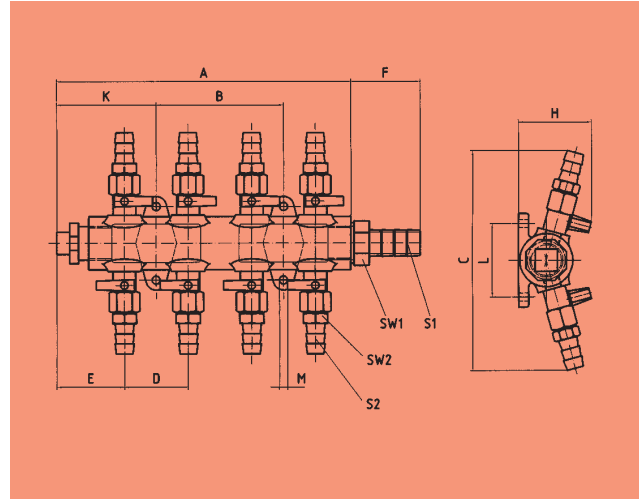

Vacuum distributors VTB-8

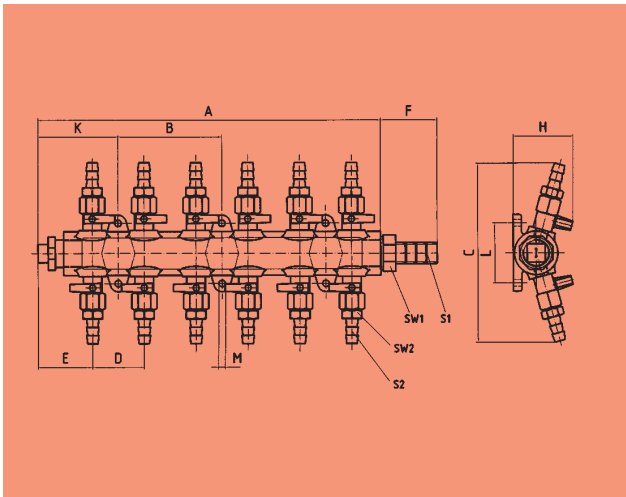

Vacuum distributors VTB-12

Dimensions							
Type	K	L	M	SW 1	S 1 LW	SW 2	S 2 LW
VTB-4-EIN-R1/2-AUS-6mm	78	58	6,4	32	1/2"	17	6
VTB-4-EIN-R1/2-AUS-10mm	78	58	6,4	32	1/2"	19	10
VTB-4-EIN-R3/4-AUS-6mm	78	58	6,4	32	3/4"	17	6
VTB-4-EIN-R3/4-AUS-10mm	78	58	6,4	32	3/4"	19	10
VTB-8-EIN-R1/2-AUS-6mm	78	58	6,4	32	1/2"	17	6
VTB-8-EIN-R1/2-AUS-10mm	78	58	6,4	32	1/2"	19	10
VTB-8-EIN-R3/4-AUS-6mm	78	58	6,4	32	3/4"	17	6
VTB-8-EIN-R3/4-AUS-10mm	78	58	6,4	32	3/4"	19	10
VTB-12-EIN-R1/2-AUS-6mm	78	58	6,4	32	1/2"	17	6
VTB-12-EIN-R1/2-AUS-10mm	78	58	6,4	32	1/2"	19	10
VTB-12-EIN-R3/4-AUS-6mm	78	58	6,4	32	3/4"	17	6
VTB-12-EIN-R3/4-AUS-10mm	78	58	6,4	32	3/4"	19	10

Description

Very robust vacuum feeder for rotation elements in aluminium design.

Depending on the design the vacuum feeders are set for low or high speeds. By using special o-ring seals and bearing drenched in oil they are absolutely leakage-free and can be mounted in any position. When mounting please take care that the flow air is filtered (see vacuum filters).



DVZ-R1/4-250U/m

Article numbers

Type	Revolving vacuum feeders
DVZ-R1/4-250U/MIN	1.54.2.0005
DVZ-R1/2-250U/MIN	1.54.2.0001
DVZ-R1/4-3500U/MIN	1.54.2.0006
DVZ-R1/2-3500U/MIN	1.54.2.0003
DVZ-R3/4-3500U/MIN	1.54.2.0009
DVZ-R1-3000U/MIN	1.54.2.0007

Technical Data

Type	Speed (1/ min)	Max. vacuum %	Weight (kg)	Temperature range (°C)
DVZ-R1/4-250U/MIN	250	93	0,3	5 - 120
DVZ-R1/2-250U/MIN	250	93	1,2	5 - 120
DVZ-R1/4-3500U/MIN	3500	93	0,4	5 - 120
DVZ-R1/2-3500U/MIN	3500	93	0,7	5 - 120
DVZ-R3/4-3500U/MIN	3500	93	1,6	5 - 120
DVZ-R1-3000U/MIN	3000	93	2,1	5 - 120

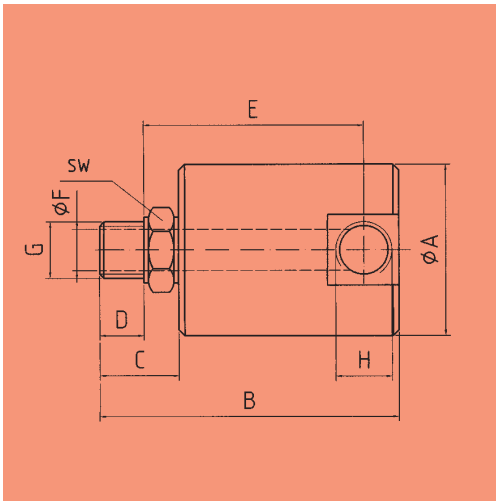

DVZ-R1/4-250U/min to DVZ-R1-3000U/min

Dimensions									
Type	A	B	C	D	E	F	G	H	SW
DVZ-R1/4-250U/MIN	38	83,3	28,5	16	40	8	G 3/8"	G 1/4"	22
DVZ-R1/2-250U/MIN	70	116	38	19	59	16	G 3/4"	G 1/2"	36
DVZ-R1/4-3500U/MIN	41,2	81	29	11,5	60	6,4	G 1/4"	G 1/4"	22
DVZ-R1/2-3500U/MIN	57,1	113	34	17,5	78	12,7	G 1/2"	G 1/2"	30
DVZ-R3/4-3500U/MIN	73	128	34	17	94	17,5	G 3/4"	G 3/4"	36
DVZ-R1-3000U/MIN	82,6	150	42	22	108	22,2	G 1"	G 1"	36

Description

Quick-change couplings are employed wherever suction circuits or suction plates need to be exchanged. The quick-change couplings are made of brass and completely leakage-free. They can be easily fit together. To separate them, simply pull the outer ring downwards and remove the plug coupling. The quick-change couplings lock on both sides and are also suitable for compressed air and liquids.



Quick-change couplings SWK-1/2 H and SWK-1/2 S

Article numbers

Type	Complete set (K)	Socket (F)	Plug (S)
SWK-1/4-	1.54.2.0050	1.54.2.0046	1.54.2.0042
SWK-1/2-	1.54.2.0051	1.54.2.0047	1.54.2.0043
SWK-3/4-	1.54.2.0052	1.54.2.0048	1.54.2.0044
SWK-1-	1.54.2.0053	1.54.2.0049	1.54.2.0045

- Quick-change coupling SWK...-K Complete set consisting of hat and plug coupling
- Quick-change coupling SWK...-F Coupling socket
- Quick-change coupling SWK...-S Coupling plug

Technical Data

Type	Thread	Design	Weight (kg)
SWK-1/4-F	R 1/4"	Brass	0,2
SWK-1/4-S	R 1/4"	Brass	0,1
SWK-1/2-F	R 1/2"	Brass	0,4
SWK-1/2-S	R 1/2"	Brass	0,2
SWK-3/4-F	R 3/4"	Brass	0,9
SWK-3/4-S	R 3/4"	Brass	0,5
SWK-1-F	R 1"	Brass	1,4
SWK-1-S	R 1"	Brass	0,8

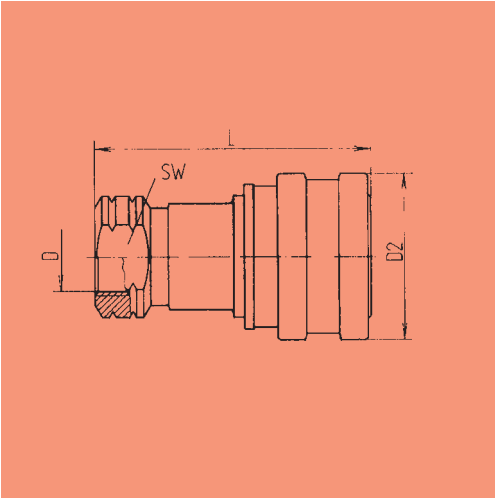

Quick-change coupling SWK 1/4" to 1" - H (hat coupling)

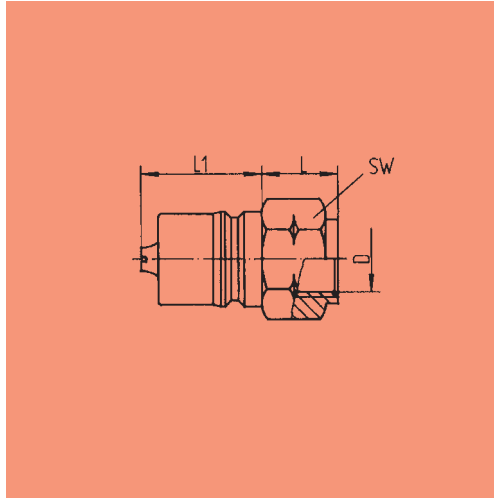

Quick-change coupling SWK 1/4" to 1" - S (plug coupling)

Article numbers					
	D	D2	L	L1	SW
SWK-1/4-F	R 1/4"	30	58	---	19
SKK-1/4-S	R 1/4"	---	14	25	19
SWK-1/2-F	R 1/2"	48	75	---	29
SKK-1/2-S	R 1/2"	---	19	32	29
SWK-3/4-F	R 3/4"	56	89	---	34
SWK-3/4-S	R 3/4"	---	17	42	34
SKK-1-F	R 1"	66	105	---	41
SKK-1-S	R 1"	---	24	47	42

Description

Liquid-separator with manual drain and monitoring window for visual control.

By means of a two-staged cleaning (draining of hard components and liquids) these separators are mainly used in fields of handling, in which the transported good is wet or moist (as outside, working with stones and woods). An additional filter with a pore-width of 50 - 75 µm guarantees the draining of the smallest hard components. When mounting, note the direction of flow (marked with an arrow)!



Water separators WA-R1/2 to WA-R1

Article numbers	
Type	Water separator
WA-R1/2	1.53.4.0001
WA-R3/4	1.53.4.0002
WA-R1	1.53.4.0006

Technical Data				
Type	Mounting pos.	Working temp. (°C)	Cont. capacity (ml)	Pressure (bar)
WA-R1/2	vertical	0 ÷ 50	80	- 1 to 16
WA-R3/4	vertical	0 ÷ 50	260	- 1 to 16
WA-R1	vertical	0 ÷ 50	260	- 1 to 16

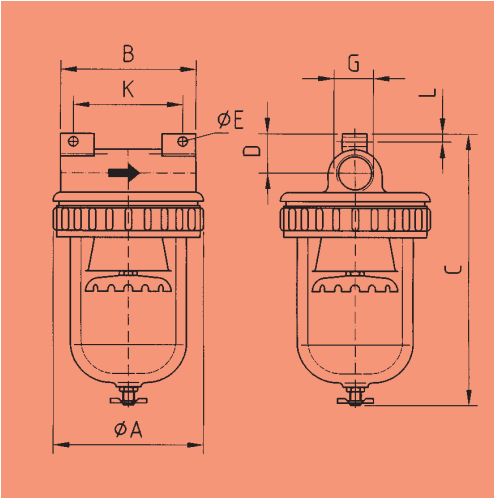

Water separators WA-R1/2 to WA-R1

Dimensions								
Type	A	B	C	D	E	G	K	L
WA-R1/2	87	80	196	24	6	G 1/2"	50	6
WA-R3/4	87	90	213	38	6	G 3/4"	97	6
WA-R1	87	90	213	38	6	G 1"	97	6